

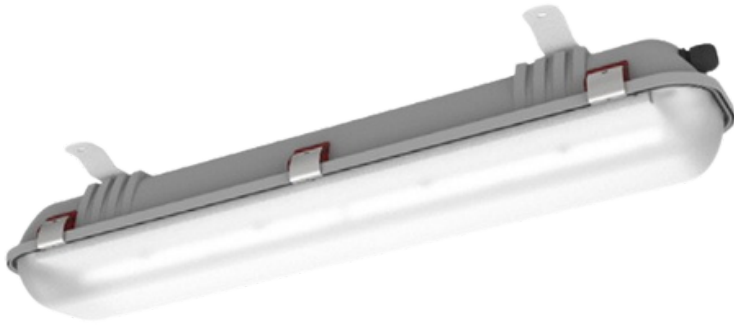

Hazardous
Lighting Solutions LTD



EXF250LED



CHEMICAL
WAREHOUSES



PASSAGeways



CHEMICAL



REFINERIES

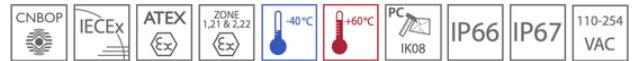

II 2G Ex eb mb op is IIC T5 Gb
II 2D Ex tb op is IIIC T55°C Db or T70°C Db

Certificate: CNBOP no. 3529/2019

MECHANICAL FEATURES

Housing: Glass Fibre Reinforced Polyester (GRP)

Diffuser: Polymethyl Methacrylate (PMMA) or UV Stabilised Polycarbonate

Ingress protection: IP66, IP67

Protection class: I

Mounting: on the surface or with connections

ELECTRICAL FEATURES

Connection terminals: 2,5mm

Input voltage: 110-254V 50-60 Hz, 220-250V 0Hz

Light source: Intrinsically safe LED modules

Power factor: >0,97

Cable inlets: Ø20

Overvoltage protection: 2kV

WORK PARAMETERS

Ambient Temperatures: -40°C to + 60°C

Lifetime: >70.000h L80 B10

PHOTOMETRICAL PARAMETERS

CRI: >80

Colour temperature: 4000k, 6500K - optional

DIMENSIONS

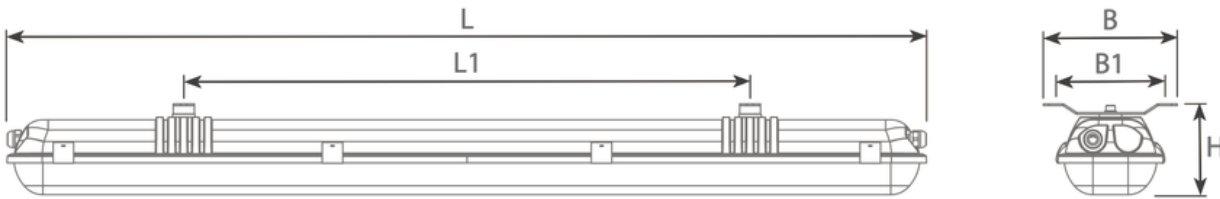

TYPES	L (mm)	L1 (mm)	B (mm)	B1 (mm)	H (mm)	APPROX. WEIGHT
EXF250LED-0600	700	450	190	160	129	5.5 kg
EXF250LED-1200	1300	800	190	160	129	9 kg

STANDARD TYPES COMPARISON

VERSION HIGH OUTPUT +45°C

TYPE OF THE LIGHTING	LUMINOUS FLUX [lm]	POWER SUPPLY [W]	EFFICIENCY [lm/W]	MAX. AMB. TEMP. [°C]
EXF250LED-0600-F1	1869	21.2	88	45
EXF250LED-0600-F2	3816	38.6	100	45
EXF250LED-1200-F2	4104	38.6	106	45
EXF250LED-1200-F4	7753	78.1	100	45

VERSION HIGH TEMPERATURE +55°C

TYPE OF THE LIGHTING	LUMINOUS FLUX [lm]	POWER SUPPLY [W]	EFFICIENCY [lm/W]	MAX. AMB. TEMP. [°C]
EXF250LED-1200-G4	4840	47.0	103	55

CENTRAL BATTERY VERSION

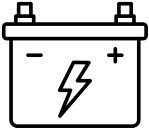

CENTRAL BATTERY: VERSION ADAPTED TO BE POWERED FROM CENTRAL BATTERY



3H

EMERGENCY POWER MODULE: VERSION WITH 3H EMERGENCY POWER MODULE. THE POSSIBILITY OF WORK ABOVE -200 C.

MEAN EMERGENCY LUMINOUS FLUX

TYPE OF THE FITTING	VERSION A3 [lm]	VERSION ZB [lm]
EXF250LED-0600-F1	88	1869
EXF250LED-0600-F2	179	3816
EXF250LED-0600-G2	121	2566
EXF250LED-1200-F2	193	4104
EXF250LED-1200-F4	193	7753
EXF250LED-1200-G2	116	2468
EXF250LED-1200-G4	227	4840

ADDITIONAL PICTOGRAM



Self-adhesive pictograms can be added to the order optionally.



MOUNTING

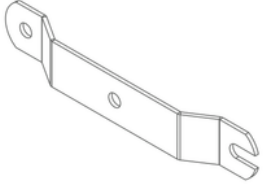

AMO1

standard mounting bracket made of 1.5mm thick steel, mounting hole spacing 160mm

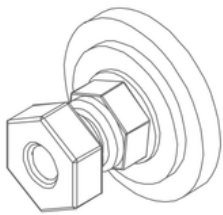
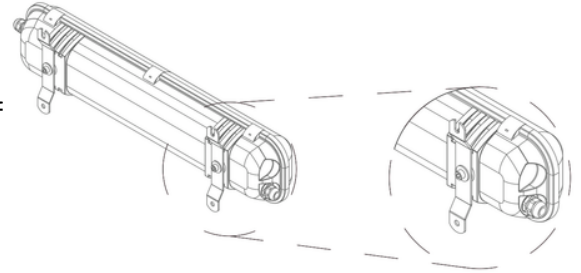

BK

standard bolt kit made to install the light fitting on the thin surfaces or the cable trays

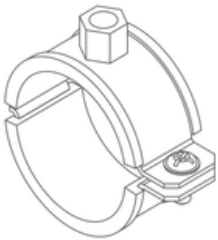
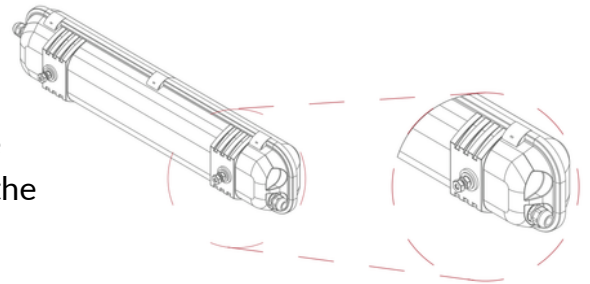

AMO3

stainless steel hoop for pipe of diameter: 26-30mm, 31-36mm, 41-46mm, 47-52mm, 59-64mm Please indicate size when ordering

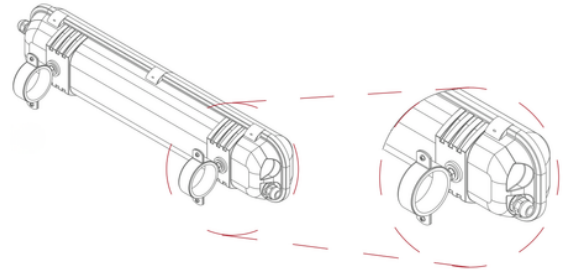

AMO3

bracket for installation at 45o

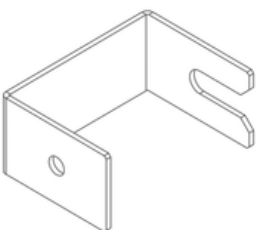
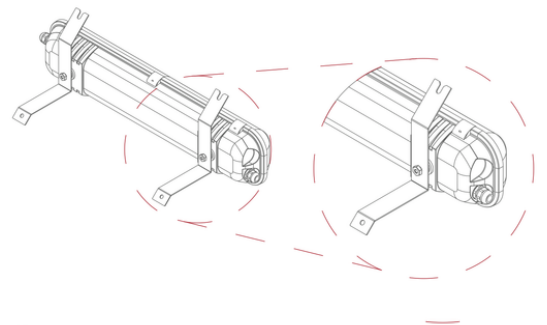

AMO5

68mm distance bracket

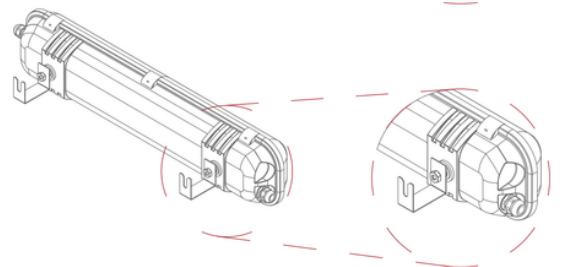

PHOTOMETRY

