



Hazardous
Lighting Solutions LTD



HPL440LED

Industrial floodlight with LED modules with very high output.



PASSAGEWAYS

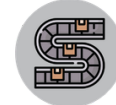

PRODUCTION LINES



WAREHOUSES



INDUSTRIAL BUILDINGS



BLAST PROTECT



-40°C



+60°C



NARROW BEAM



WIDE BEAM



VIBRO PROOF



LED OPTICS



HIGH OUTPUT



HIGH EFFICIENCY



IP65

MECHANICAL FEATURES

Housing: powder coated galvanized steel

Diffuser: tempered glass

Ingress protection: IP65

Protection class: I

Mounting: mounting on a bracket

Accessories: vibroinsulators, blastproof diffuser

ELECTRICAL FEATURES

Connection terminals: 2.5 mm²

Power supply: 230V, 50-60Hz

Source of light: certified LED modules

Power factor: >0.95

Cable inlets: Ø20

Overvoltage protection: L-N: 6 kV

L/N-PE: 2 kV

WORK PARAMETERS

Ambient temperature: -40°C to +60°C (check: types comparison)

Lifetime: >70,000h (L80 B10)

PHOTOMETRICAL PARAMETERS

CRI: >70 (>80 optional)

Colour temperature: 4000K

DIMENSIONS

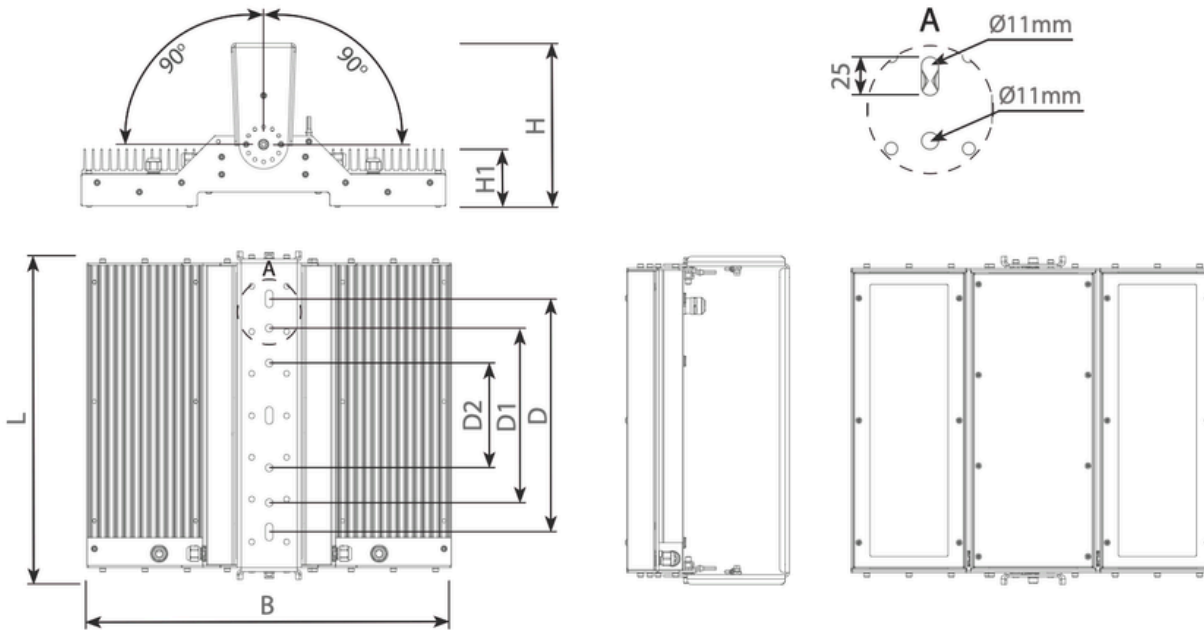

Type	L	B	H	H1	D	D1	D2
HPL440LED	470	522	235	100	334	250	150

TYPE COMPARISONS

TYPES COMPARISON +60°C

Type of the Fitting	Luminous Flux [lm]	Power Consumption [W]	Efficiency [lm/W]	Max. Amb. Temp. [°C]
HPL440LED-080-H4	10,550	82	129	60
HPL440LED-130-H8	16,606	128	130	60

TYPES COMPARISON +55°C

Type of the Fitting	Luminous Flux [lm]	Power Consumption [W]	Efficiency [lm/W]	Max. Amb. Temp. [°C]
HPL440LED-170-H8	20,738	173	120	55

TYPES COMPARISON +40°C

Type of the Fitting	Luminous Flux [lm]	Power Consumption [W]	Efficiency [lm/W]	Max. Amb. Temp. [°C]
HPL440LED-250-H8	27,402	235	117	40

OPTIONAL EQUIPMENT

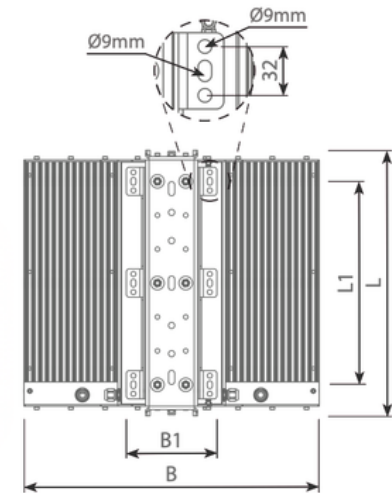
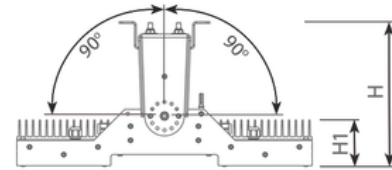
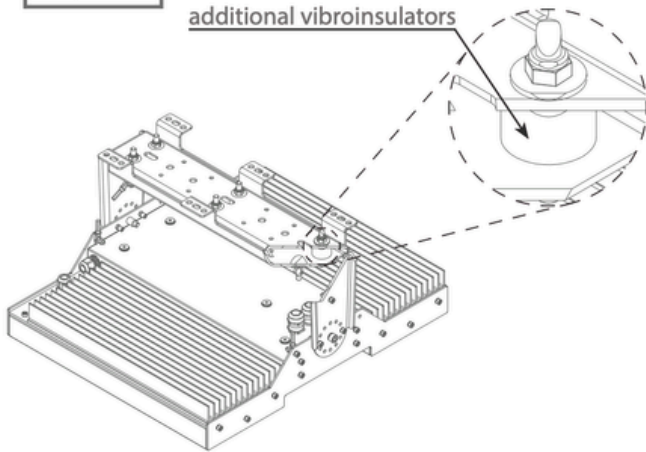

Type	L [mm]	L1 [mm]	H [mm]	H1 [mm]	B [mm]	B1 [mm]
HPL440LED	470	360	255	100	522	135

ADDITIONAL PROTECTION

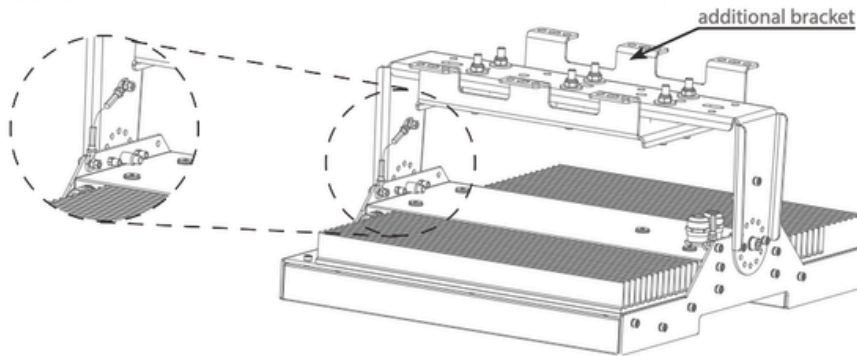

Fig. 1.1

- ADDITIONAL INFORMATION:**
1. A special anaerobic adhesive was used to increase durability and safety on sensitive threaded connections and it prevents self-loosening of parts subjected to vibrations.
 2. The luminaire is additionally secured with a protective cable (see Fig. 1.1).
 3. An additional bracket made of high-grade stainless steel increases safety in case of damage to damped elements (see Fig. 1.2).

ADDITIONAL BRACKET

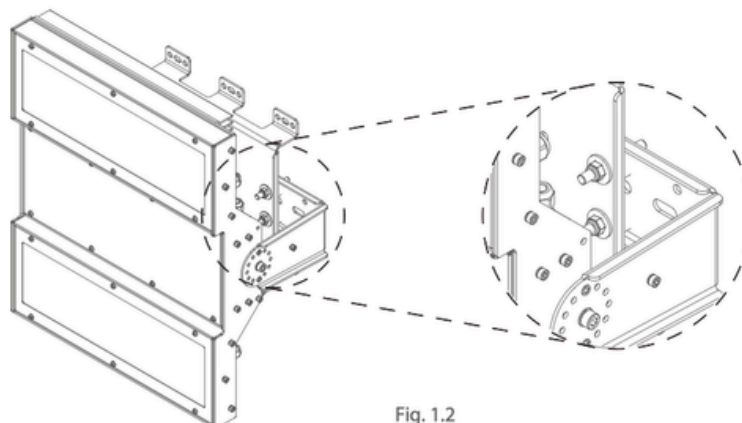

Fig. 1.2

OPTIONAL EQUIPMENT



OPTIONAL VIBRATIONPROOF VERSION (BP)

Version is equipped with an easily replaceable, additional polycarbonate diffuser that protects the glass from any damage

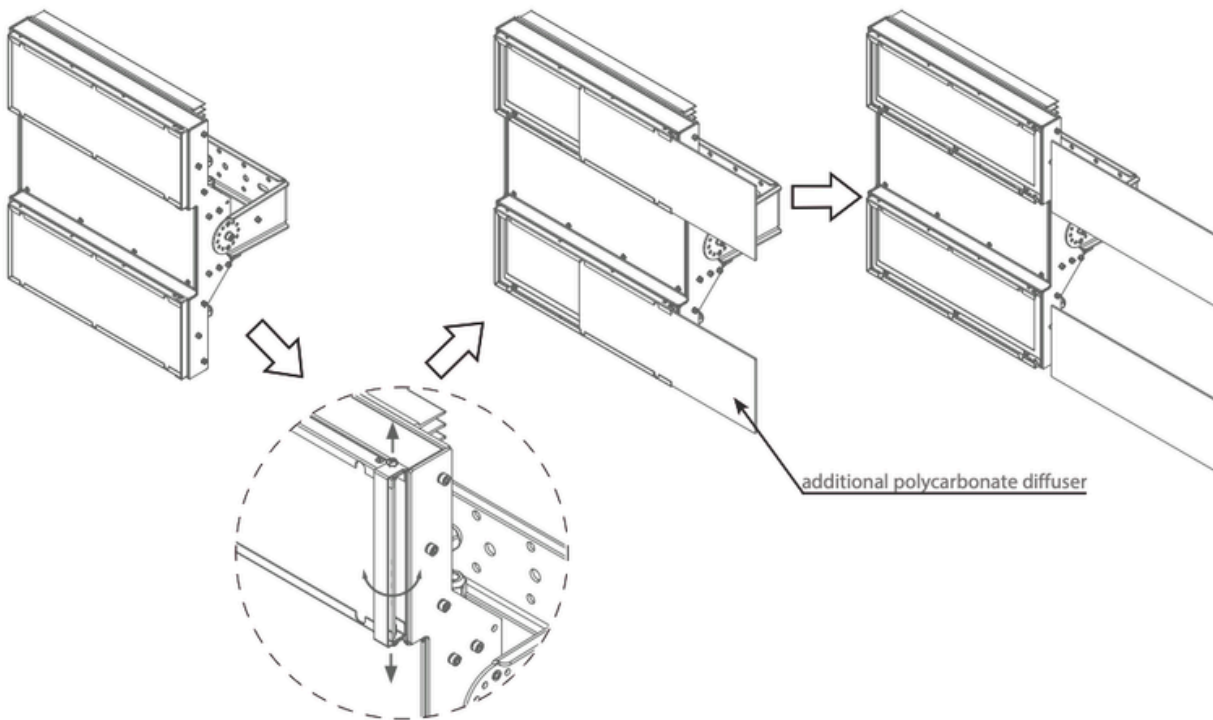

PHOTOMETRY

NARROW BEAM

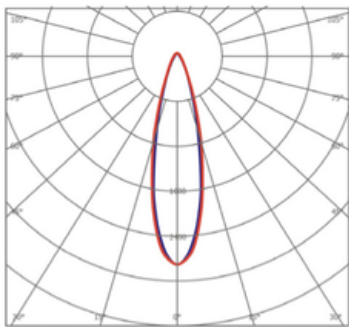

MEDIUM BEAM

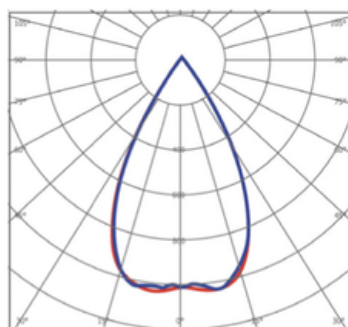

WIDE BEAM

